

**MOTHERS,
CHILDREN &
HOPE: KEEPING
FAMILIES
CONNECTED
THROUGH
INCARCERATION**

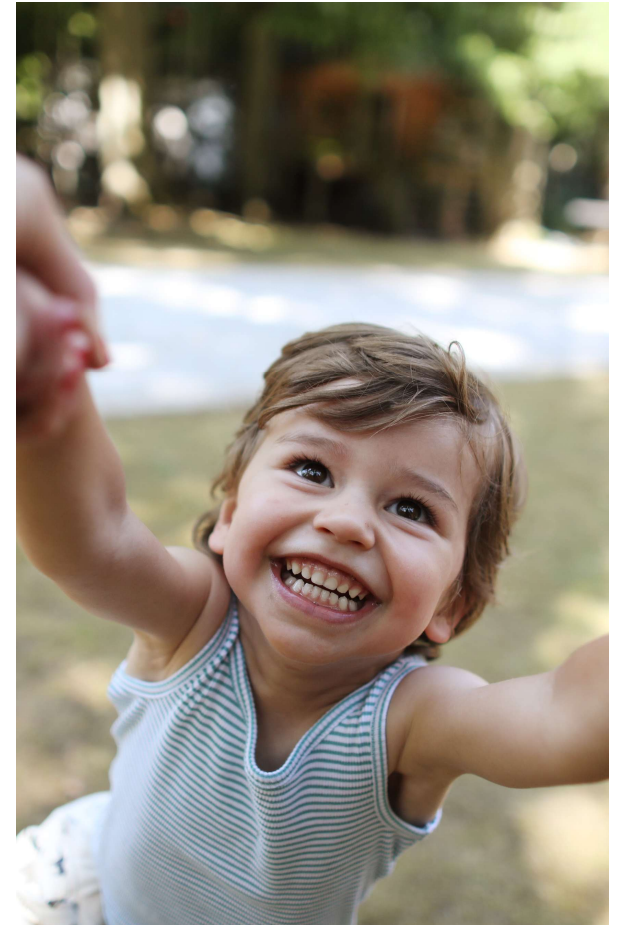



About COIPI

In 2018, the DOCR started the Children of Incarcerated Parents Initiative. This Initiative is comprised of team members from the ND DOCR, Health and Human Services, school systems and community partners to focus on ways to increase visitation and family activities within all ND DOCR facilities. The ND DOCR is also committed to focusing on enriching the contact between an incarcerated parent and their child(ren), reducing risk factors affected by parental incarceration and recidivism for the incarcerated parent.



Increase in Prison Population

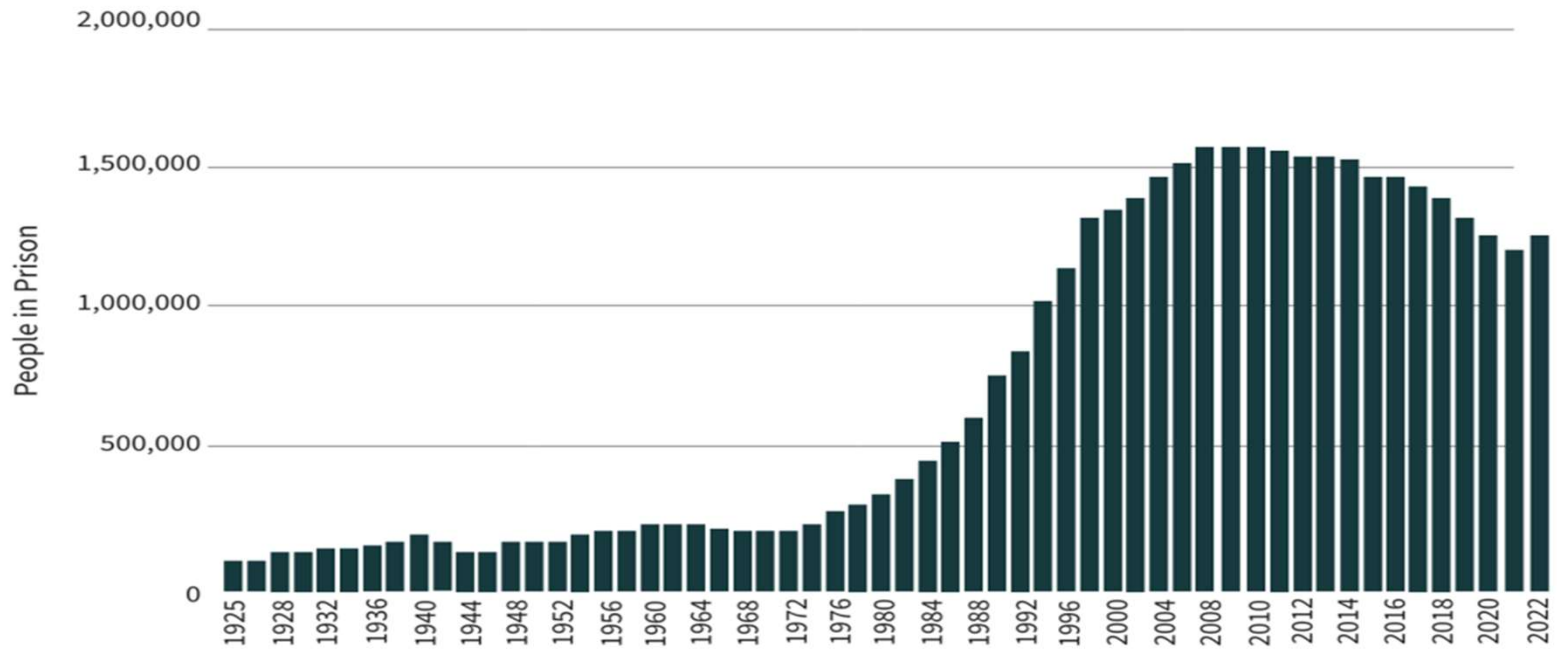

Offense Types Men vs. Women

- Women are more likely than men to be incarcerated for drug or property offenses.
- 26% of women have been convicted of a drug offense, compared to 12% of men.
- 18% of women have been convicted of a property offense, compared to 12% of men.
- In 1986, 12% of women were incarcerated for a drug offense.
- In 2022, 26% of women were incarcerated for drug offenses.



Offense Types Men vs. Women

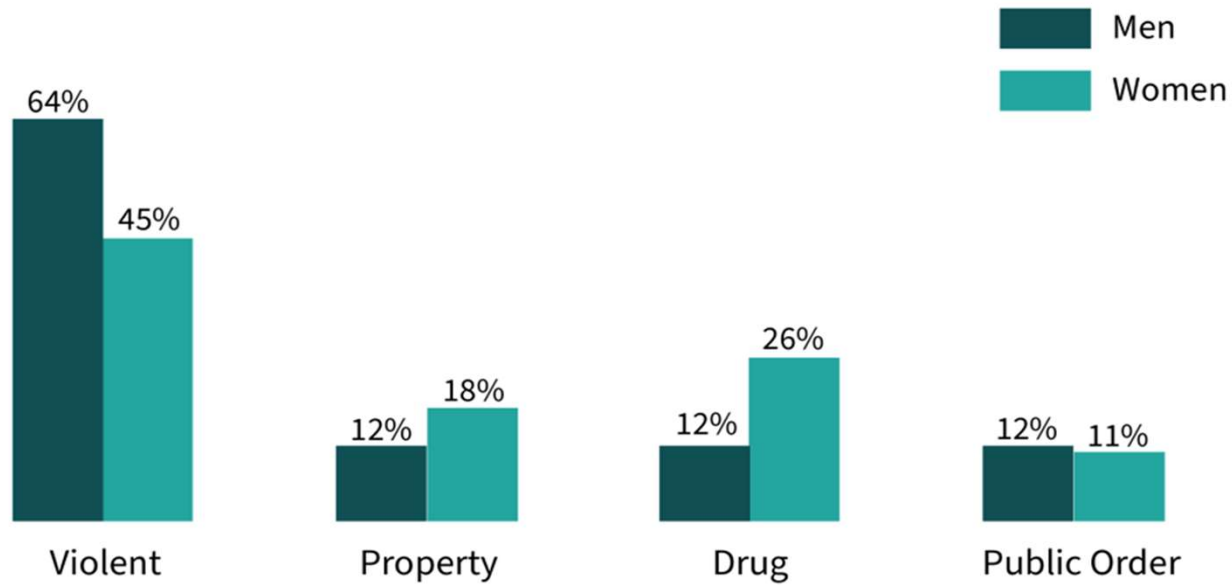

Incarcerated Women

- Incarcerated women enter the criminal justice system in different ways than men.
- Incarcerated women who commit crimes are also more likely to suffer from co-occurring substance use and mental health disorders.
- Incarcerated women that maintain contact with their children and families are less likely to report depression while incarcerated and are more likely to achieve family reunification following release.



Incarcerated Women

- Between 1980 and 2023, the number of incarcerated women increased by over 600%, rising from 26,326 in 1980 to 186,244 in 2023.
- Though many more men are in prison than women, the rate of growth for women incarcerated has been twice as high as that of men since 1980.
- In 2023, over 1 million women were under the supervision of the criminal justice system.

Incarceration impacts

- More than 10 million children live with a parent who has been involved in the criminal justice system at some point, and approximately 1 in 28 children have a parent who is currently incarcerated.
- 62% of incarcerated women are parents to children under the age of 18.
- The average incarcerated woman has about 2.5 children.
- Any given year, almost 200,000 children experience the incarceration and subsequent reentry of their primary caregiver.

Incarceration impacts

- In December of 2022 the ND DOCR had 143 incarcerated women report over 375 children under the age of 18, that were not in their care due to incarceration.
- Children that have an incarcerated parent are at a higher risk of adverse childhood experiences (ACE), insecure attachment, social stigma, unstable family relationships, physical and mental health issues and low educational attainment.

Incarceration impacts

- Roughly 97% of the incarcerated women's population in ND will return to their family and communities after incarceration.
- Contact between incarcerated parent(s) and their children can help reduce risk factors for the children affected by parental incarceration as well as reducing recidivism for the incarcerated parent, as more than 40% of incarcerated parents lived with their children prior to their incarceration.



Connecting families

A strong family support, including contact with children, is a significant factor in successful reintegration into society after release.

Children who maintain contact with their incarcerated parents often exhibit better social skills, emotional regulation and fewer behavioral problems.

Resources & Re-Entry

NDSP podcast Chainz 2 Changed
Friends and Family Handbook
Relational Model - Dynamic Security –
Import Model – Normalization
Partnering with Job Services and
Vocational Rehabilitation to secure
employment upon release

Re-entry Simulator
Partnering with Human Service Centers for
mental health follow up
New women's facility being built in
Mandan: Broke ground in April of 2025,
projected opening in the Fall of 2027
Overnight visitation center/nursery

DOCR Website:

[Home | North Dakota Department of Corrections and
Rehabilitation](#)

[Resident Look Up](#)

Children of Incarcerated Parents website:

[Children of Incarcerated Parents \(COIP\) | North
Dakota Department of Corrections and Rehabilitation](#)



Resources & Re-Entry

Revamping visitation rooms and application process to
visit incarcerated loved ones

Community Resource Fairs



Did you know...

These States all have nurseries within their women's prison facilities

California-2011

New York-1901

Delaware-2014

Ohio-2001

Illinois-2007

South Dakota-1998

Indiana-2008

Texas-2010

Missouri-2025

Washington State-1999

Nebraska-1994

West Virginia-2009

Bureau of Prisons

Did you know...

New York - longest running prison nursery, reports only a 3% recidivism rate, compared to 30% for other female offenders.

Washington – reports only a 3-5% recidivism rate, compared to a state average of 30%.

Nebraska – seeing a 20%  in recidivism

Texas - seeing a 10%  in recidivism

Indiana & Ohio – seeing a 16%  in recidivism

Did you know...

Illinois - from 2007-2016 saw only 3 or 78 nursery participants return to prison, also reporting an 80% overall success rate.

California - have only had 2 nursery participants return to prison.

Delaware - in a one-year period, 23 participants completed the nursery program and only one returned to prison.

West Virginia - has never had a nursery participant return to prison.

Why a prison nursery...

The priority of the nursery is the child's well-being.

Attachment Theory

Reunification

The nursery and overnight visitation are opportunities to provide education and support to these mothers and their children to help aide them in successful return to our communities.



MOTHERS, CHILDREN & HOPE: KEEPING FAMILIES
CONNECTED THROUGH INCARCERATION



SB 2352 – Nursery Bill

SB 2352 – authorizes children of pregnant mothers to reside with their mother while she is incarcerated at HRCC

ND is the 13th State to have a nursery within their women's prison facility.

Comprehensive application process to be considered for this program

Father must agree to the child living with their mother at HRCC

The mother must affirm that they will be the primary care giver upon release

The child can reside with their mother up to 18 months of age

The mother and child must release together within those 18 months

The child will be covered under ND Medicaid

Overnight Visitation

Tennessee, Washington State and Nebraska currently offer overnight visitation within their women's facilities.

Will be an apartment style area with bedrooms, a full kitchen, bathroom and living room.

Attached to visitation area, so separate from general housing.
Will have access to outdoor areas of visitation.

Allow a mother who is working towards reunification with her child(ren) to set boundaries, structure and helping to transition both the mother and her child(ren) into a family routine.

New Women's Facility Project Pillars

Normality

Dynamic Security

Progression

Import Model

Team Member Wellness



Design Matters



CARVING A NEW PATH LIKE A RIVER THROUGH THE LANDSCAPE

FLOW OF THE RIVER, SURROUND OF ROCKS CARVED AWAY, NATURAL LANDSCAPE - TEXTURE, FLUID FORMS, DIVETS AND NOOKS, RESPITE AND MOVEMENT, VARIATION, CALM, NATURAL PALETTE FROM THE SURROUNDING AREA.

AREAS OF RESPITE

AREAS OF GATHERING

AREAS OF MOVEMENT

BASE PALETTE

OVERALL ACCENTS



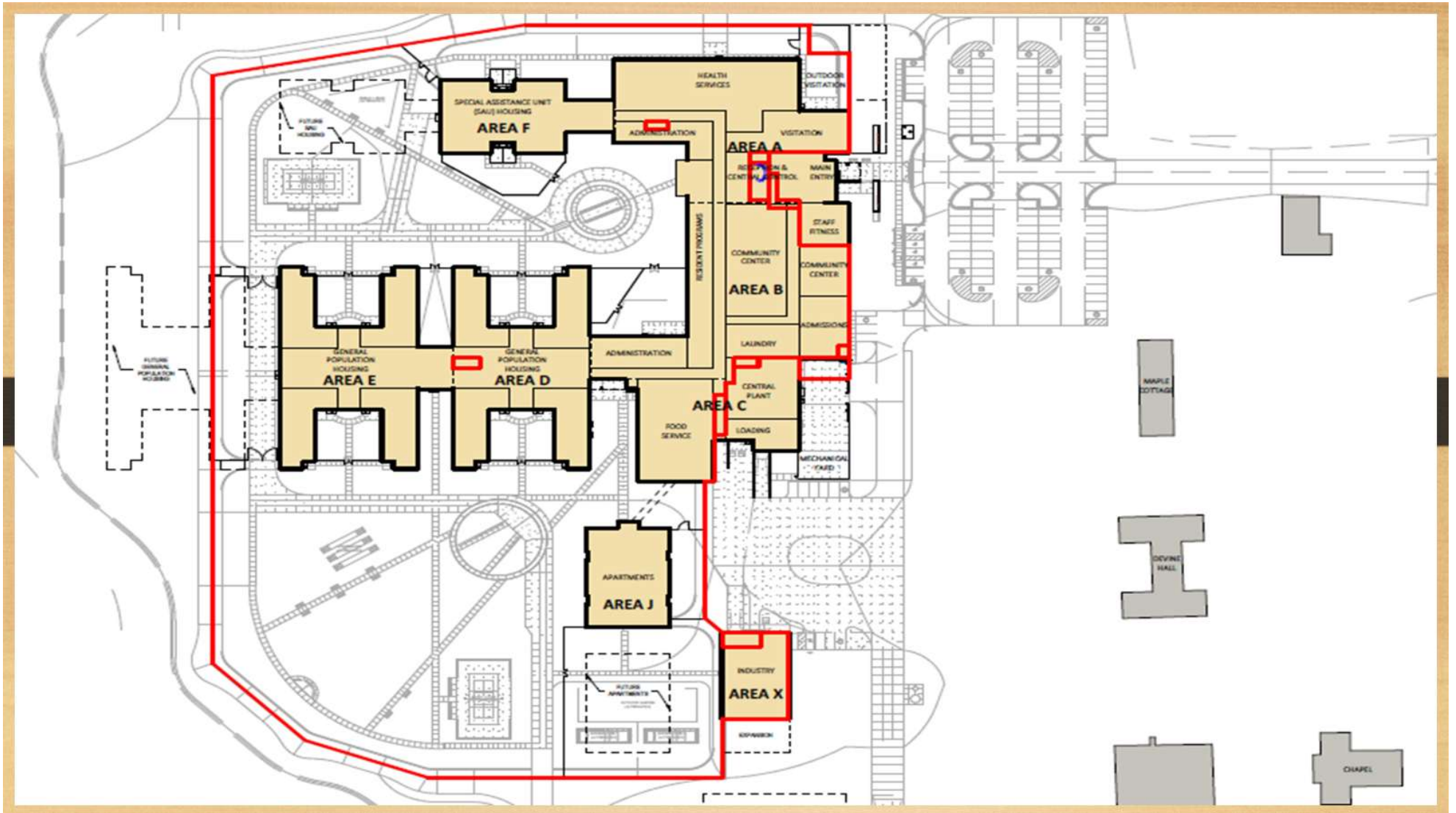

































NORTH
Dakota | Corrections and
Rehabilitation
Be Legendary.

www.docr.nd.gov



chthomas@nd.gov



701.328.3938

